

## DODGE® Sleeveoil® Heater-Thermostat Assembly

These instructions must be read thoroughly before installation or operation. This instruction manual was accurate at the time of printing. Please see [dodgeindustrial.com](http://dodgeindustrial.com) for updated instruction manuals.

**WARNING:** To ensure the drive is not unexpectedly started, turn off and lock-out or tag power source before proceeding. Failure to observe these precautions could result in bodily injury.

**WARNING:** All products over 25 kg (55 lbs) are noted on the shipping package. Proper lifting practices are required for these products.

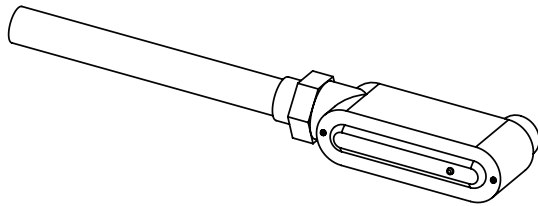

The Dodge heater and thermostat is combined into one assembly. The thermostat is built into the first 2" from the tip of the heater. The thermostat is set to turn the heater on at 70°F (21°C) and off at 100°F (38°C). Also, an LED indicates when the heater is on.

### Assembly components:

1. Heater-Thermostat
2. LED light
3. Toroid (copper winding ring)
4. LB conduit enclosure
5. Brass Reducer\*
6. Aluminum reducer (for electrical outlet)

\*Only used when the heater plug on the bearing is 1/2" or 3/4" NPT.

**WARNING:** Because of the possible danger to person(s) or property from accidents which may result from the improper use of products, it is important that correct procedures be followed. Products must be used in accordance with the engineering information specified in the catalog. Proper installation, maintenance and operation procedures must be observed. The instructions in the instruction manuals must be followed. Inspections should be made as necessary to assure safe operation under prevailing conditions. Proper guards and other suitable safety devices or procedures as may be desirable or as may be specified in safety codes should be provided, and are neither provided by Dodge nor are the responsibility of Dodge. This unit and its associated equipment must be installed, adjusted and maintained by qualified personnel who are familiar with the construction and operation of all equipment in the system and the potential hazards involved. When risk to persons or property may be involved, a holding device must be an integral part of the driven equipment beyond the speed reducer output shaft.

### Installation:

1. Shut down the main fan by following the manufacturer's instructions.
2. To prevent oil from seeping out during installation, drain the oil from the bearing until the oil level is below the heater plug. The heater plug location is specified in the appropriate Sleeveoil Instruction Manual.

**NOTE:** If the heater-thermostat is replacing an existing heater and thermostat, the old thermostat should be removed and replaced with a threaded plug.

3. Remove the heater plug.
4. Apply sealant to the pipe fitting (inner threads) on the heater-thermostat and install it in the bearing housing where the heater plug was removed. (On bearings where the heater plug is 1/2" or 3/4" NPT, use sealant to install the supplied brass reducer first.)
5. The conduit body can be mounted vertically or horizontally. Determine which mounting configuration will be easiest to install. If space limitations prevent the LB enclosure from being installed, alternate conduit can be provided by a qualified electrician. Use sealant to install the conduit body on the outer threads of the heater thermostat.
6. Wrap one of the two red power leads around the toroid (copper winding ring) 1 or 2 times. See Figure 1.
7. Connect the heater leads to a power supply and ground. The 2 red leads are 120 or 240 VAC power leads (depending on heater) and the green lead with the yellow tracer is the ground lead.
8. The aluminum reducer is for the outlet of the conduit enclosure and can be installed if desired.
9. Install the conduit body cover.
10. Fill the bearing with oil to its recommended level.

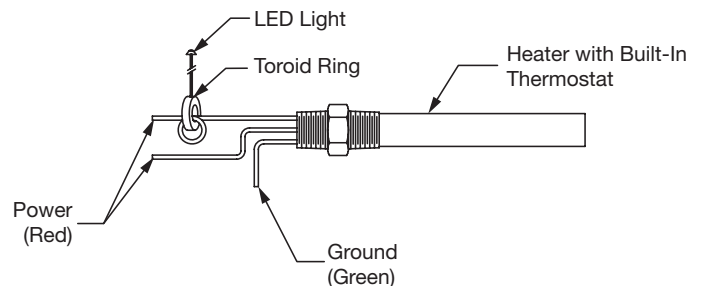

Figure 1 - Heater / Thermostat Wiring

**WARNING:** Do not start the fan if the oil temperature is too low. This can result in an insufficient oil film in the bearing which may result in bearing failure. Dodge recommends the oil temperature to be 70°F (21°C) or above.

**NOTE: Explosion-proof enclosures are available. Contact your local representative for details.**

**WARNING: Install wiring in accordance with the National Electrical Code and local codes. Failure to observe these guidelines could result in electrical shock.**

**Table 1 - Part Number Table**

Shaft Size	Part Number	RTL - Heater / Thermostat Combo - 120 V
2-15/16	434721	175 W 120 V Immersion Heater / T-Stat Combo
3-7/16	434721	175 W 120 V Immersion Heater / T-Stat Combo
3-15/16	434725 **	260 W 120 V Immersion Heater / T-Stat Combo
4-7/16	434725 **	260 W 120 V Immersion Heater / T-Stat Combo
4-15/16	434727	480 W 120 V Immersion Heater / T-Stat Combo
5-7/16	434727	480 W 120 V Immersion Heater / T-Stat Combo
6	434727	480 W 120 V Immersion Heater / T-Stat Combo
7	434729	740 W 120 V Immersion Heater / T-Stat Combo
8	434729	740 W 120 V Immersion Heater / T-Stat Combo
9	434729	740 W 120 V Immersion Heater / T-Stat Combo
10	434729	740 W 120 V Immersion Heater / T-Stat Combo
12	434735	1600 W 120 V Immersion Heater / T-Stat Combo
Single unit - 120V Combination Heater and Thermostat		
** Brass reducer not required		

Shaft Size	Part Number	RTL - Heater / Thermostat Combo - 240 V
2-15/16	434722	175 W 240 V Immersion Heater / T-Stat Combo
3-7/16	434722	175 W 240 V Immersion Heater / T-Stat Combo
3-15/16	434726 **	260 W 240 V Immersion Heater / T-Stat Combo
4-7/16	434726 **	260 W 240 V Immersion Heater / T-Stat Combo
4-15/16	434728	480 W 240 V Immersion Heater / T-Stat Combo
5-7/16	434728	480 W 240 V Immersion Heater / T-Stat Combo
6	434728	480 W 240 V Immersion Heater / T-Stat Combo
7	434730	740 W 240 V Immersion Heater / T-Stat Combo
8	434730	740 W 240 V Immersion Heater / T-Stat Combo
9	434730	740 W 240 V Immersion Heater / T-Stat Combo
10	434730	740 W 240 V Immersion Heater / T-Stat Combo
12	434736	1600 W 240 V Immersion Heater / T-Stat Combo
Single unit - 240V Combination Heater and Thermostat		
** Brass reducer not required.		

Shaft Size	Part Number	R-Series - Heater / Thermostat Combo - 120 V
2-7/16 *	132834	50 W 120 V Immersion Heater
2-11/16 *	132834	50 W 120 V Immersion Heater
2-15/16 *	132834	50 W 120 V Immersion Heater
3-7/16	434719	100 W 120 V Immersion Heater / T-Stat Combo
3-15/16	434721	175 W 120 V Immersion Heater / T-Stat Combo
4-7/16	434721	175 W 120 V Immersion Heater / T-Stat Combo
4-15/16	434721	175 W 120 V Immersion Heater / T-Stat Combo
5-7/16	434721	175 W 120 V Immersion Heater / T-Stat Combo
6	434725 **	260 W 120 V Immersion Heater / T-Stat Combo
7	434725 **	260 W 120 V Immersion Heater / T-Stat Combo
8	434727	480 W 120 V Immersion Heater / T-Stat Combo
9 XC	434729	740 W 120 V Immersion Heater / T-Stat Combo
9 PL	434727	480 W 120 V Immersion Heater / T-Stat Combo
10 XC	434729	740 W 120 V Immersion Heater / T-Stat Combo
10 PL	434727	480 W 120 V Immersion Heater / T-Stat Combo
12 XC	434729	740 W 120 V Immersion Heater / T-Stat Combo
12 PL	434729	740 W 120 V Immersion Heater / T-Stat Combo
14 PL	434729	740 W 120 V Immersion Heater / T-Stat Combo
Single unit - 120V Combination Heater and Thermostat		
* Requires listed heater part number and thermostat p/n 133116		
** Brass reducer not required.		

Shaft Size	Part Number	R-Series - Heater / Thermostat Combo - 240 V
2-7/16 *	434835	50 W 240 V Immersion Heater
2-11/16 *	434835	50 W 240 V Immersion Heater
2-15/16 *	434835	50 W 240 V Immersion Heater
3-7/16	434720	100 W 240 V Immersion Heater / T-Stat Combo
3-15/16	434722	175 W 240 V Immersion Heater / T-Stat Combo
4-7/16	434722	175 W 240 V Immersion Heater / T-Stat Combo
4-15/16	434722	175 W 240 V Immersion Heater / T-Stat Combo
5-7/16	434722	175 W 240 V Immersion Heater / T-Stat Combo
6	434726 **	260 W 240 V Immersion Heater / T-Stat Combo
7	434726 **	260 W 240 V Immersion Heater / T-Stat Combo
8	434728	480 W 240 V Immersion Heater / T-Stat Combo
9 XC	434730	740 W 240 V Immersion Heater / T-Stat Combo
9 PL	434728	480 W 240 V Immersion Heater / T-Stat Combo
10 XC	434730	740 W 240 V Immersion Heater / T-Stat Combo
10 PL	434728	480 W 240 V Immersion Heater / T-Stat Combo
12 XC	434730	740 W 240 V Immersion Heater / T-Stat Combo
12 PL	434730	740 W 240 V Immersion Heater / T-Stat Combo
14 PL	434730	740 W 240 V Immersion Heater / T-Stat Combo
Single unit - 240V Combination Heater and Thermostat		
* Requires listed heater part number and thermostat p/n 133116		
** Brass reducer not required.		

**Dodge Industrial, Inc.**  
 1061 Holland Road  
 Simpsonville, SC 29681  
 +1 864 297 4800

